



intact Start-Power Truck

Closed calcium or hybrid battery (Ca/Ca or Sb/Ca) | low/maintenance-free

Art.No.

72512GUG

Usage

intact Start-Power Truck

Volt	12V
Capacity	225 AH (c20)
CCR -18°C (EN)	1150 A (EN)
Electrolyte	diluted sulphuric acid
Electrolyte density	1,28 +/- 0,01 Kg/l (25° C)
Size (LxWxH)	518 x 276 x 242 mm
Weight	58 kg
Pos. of Terminal	3
Terminal	1
Base plate	-

Size

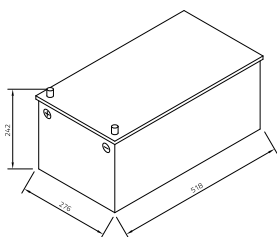

Pos. of Terminal 3

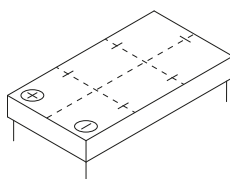

Terminal 1

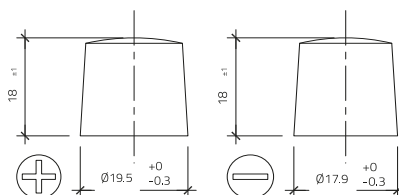

Base plate -

As of 14.07.2023