



# intAct Start-Power

Calcium or hybrid battery (Ca/Ca or Sb/Ca)

Art.No.

## 55559GUG

Volt	12V
Capacity	55 AH (c20)
CCR -18°C (EN)	420 A (EN)
Electrolyte	diluted sulphuric acid
Electrolyte density	1,28 +/- 0,01 Kg/l (25° C)
Size (LxWxH)	242 x 175 x 190 mm
Weight	13,7 kg
Pos. of Terminal	0
Terminal	1
Base plate	B13

### Usage



## Top performance at a great price

Designed for performance and extreme high current capability offering perfect value for money. For almost all passenger cars, coaches, trucks and agricultural machinery. Our recommendation for a solid battery when cost is a major consideration.

- » **Durable, safe and reliable.**
- » **2 versions:** Calcium battery (Ca/Ca) wet charged (GUG) or dry-charged (TV) hybrid battery (Sb/Ca).
- » **Low maintenance or maintenance free.**
- » Wet charged version in part with double lid for increased leak protection and vapour condensation.
- » All truck/utility and Asia models only low-maintenance (with ven caps on top).
- » Not suitable for vehicles with charging voltage 14.8 volts.

Size

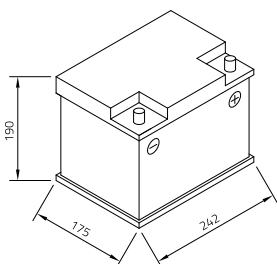

Pos. of Terminal 0

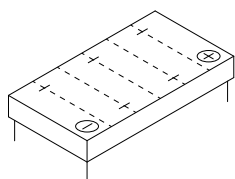

Terminal 1

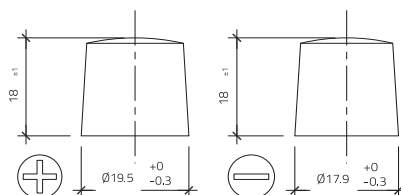

Base plate B13

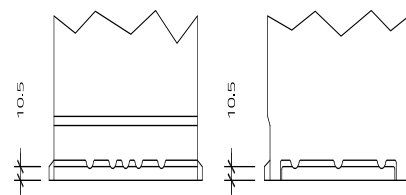

As of 14.07.2023