



intAct Start-Power NG

Maintenance-free calcium battery (Ca/Ca) | wet charged

Art.No.

54459GUG

Volt	12V
Capacity	44 AH (c20)
CCR -18°C (EN)	400 A (EN)
Electrolyte	diluted sulphuric acid
Electrolyte density	1,28 +/- 0,01 Kg/l (25° C)
Size (LxWxH)	210 x 175 x 190 mm
Weight	11,4 kg
Pos. of Terminal	0
Terminal	1
Base plate	B13

Usage



One that fits all

Fully meets the requirements of all vehicles. Both for older vehicles as well as for newer models with charging voltage up to 14.8 volts. For passenger cars, also from Asia and super-shakeproof for trucks. Our recommendation for a solid battery when cost is a major consideration.

- » **Approved for charging voltage up to 14.8 volts.**
- » **Very powerful, maintenance-free and extremely reliable.**
- » **Double lid for increased leak protection and vapour condensation** (gaseous electrolyte condenses in the labyrinth lid and remains in the circuit).
- » **2 versions: For cars (including Asia models) and Super-Heavy-Duty (SHD) for trucks.**
- » **SHD version** with glass mat separators **vibration-resistant V3**. For complexly equipped, heavy commercial vehicles even under the most difficult conditions.

Size

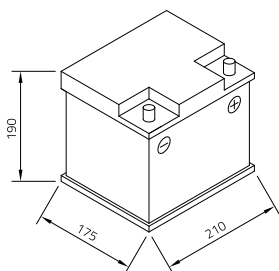

Pos. of Terminal 0

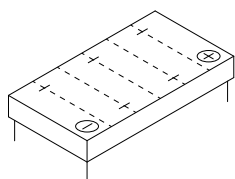

Terminal 1

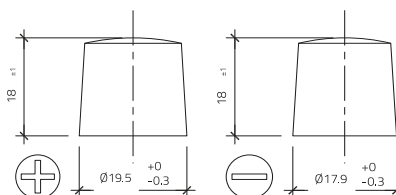

Base plate B13

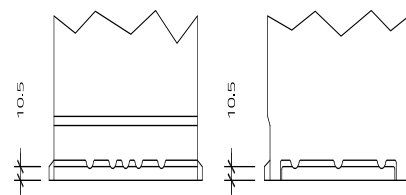

As of 14.07.2023